

-
- DESCRIPTION AND MATERIAL
- 316 stainless steel passivated per QQ-P-35 Type VI with naval bronze engaging nut.
 - Bulkhead connectors available as a threaded or flanged version with a removable glass reinforced epoxy insert. (Except for MHDG Series and CCP's)
 - Up to 61 contacts.
 - Up to 600 VDC.
 - 5,000 PSI in mated condition.
 - Bulkhead connector design open face pressure rated to 5,000 psi.
 - Contacts are gold plated per MIL-G-45204.
- USES
- For use with oil filled tubes.
 - Signal telemetry.
 - Hazardous environment.
- GUIDELINES
- Mounting torque should not exceed 150 in/lbs. for this series.
 - All mounting surfaces require a 32 finish.
 - Align indexes.
 - Keep o-ring grooves clean.
 - Avoid o-ring cuts and nicks.
 - Lubricate o-rings with Dow Corning #111 Valve Lubricant or equivalent.
 - Replace o-rings when re-using connectors.
 - Avoid contact with noxious solvents.
 - Elastomers can be seriously degraded if exposed to direct sunlight or high ozone levels for extended periods of time.
 - Slight leakage of oil through CCP face may occur.

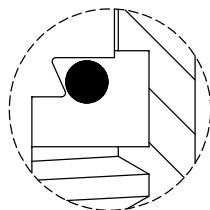

DETAIL A

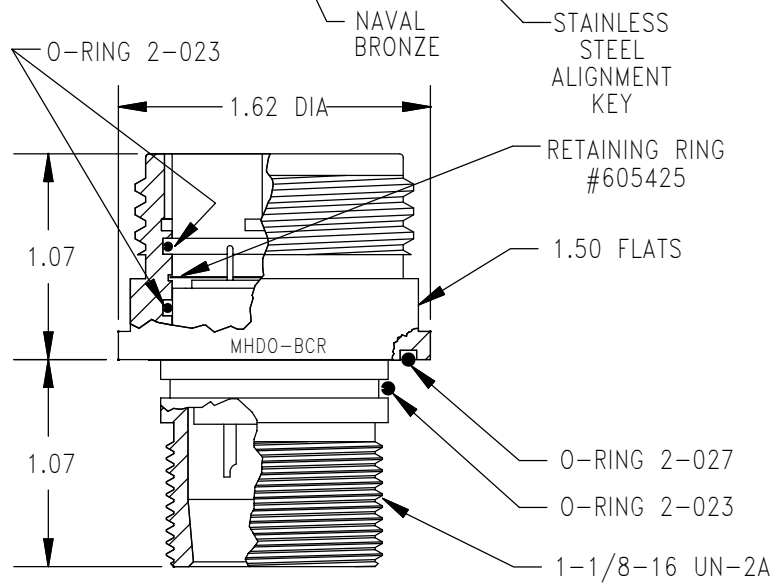
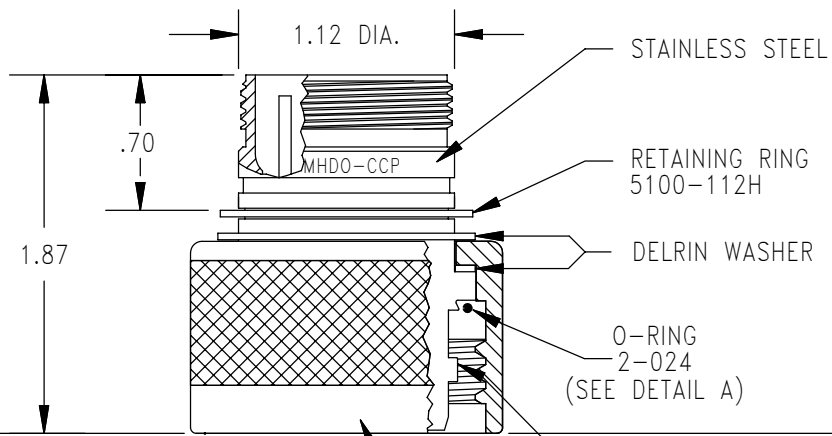
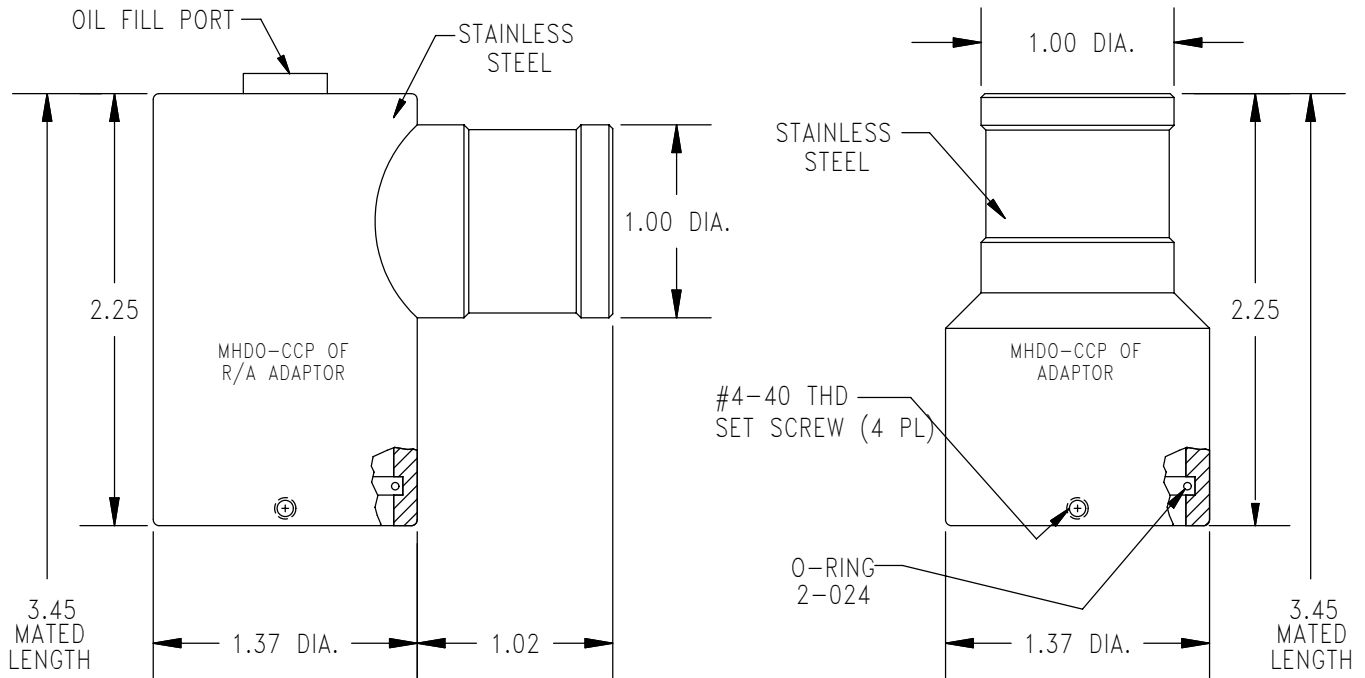
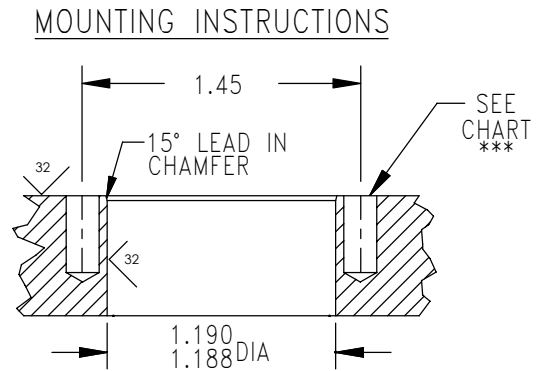
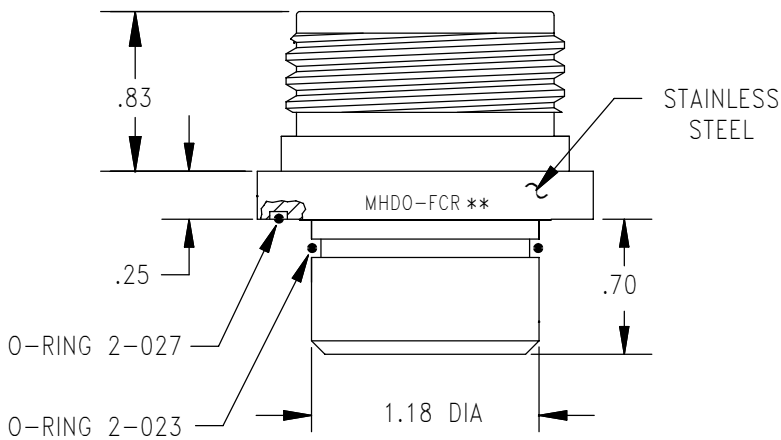
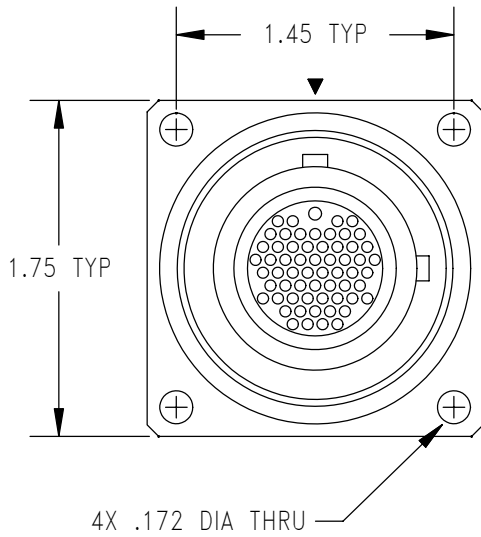

MOUNTING TORQUE FOR MHDO-BCR	not to exceed 200 in lbs	MATED PRESSURE RATING (psi)	5,000
DUMMY PLUG FOR MHDO-BCR/FCR/CCR	MHDO-SCP	DUMMY PLUG FOR MHDO-CCP	MHDO-SCR
<p>* Please specify number of contacts.</p> <p>** Internal assembly same as MHDO-BCR (facing page).</p> <p>*** Blind tapped hole not to penetrate bulkhead, minimum full thread depth 2 times bolt diameter.</p> <p>**** O-Ring installation tool available – Contact factory for further information.</p>			

CONTACT
CONFIGURATION
(BCR FACE VIEW)

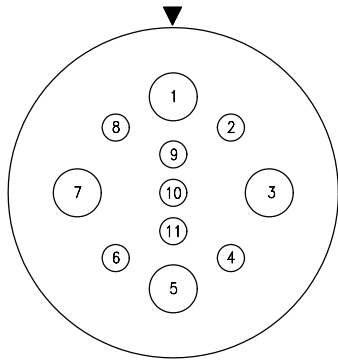

7#22
4#10
600VDC

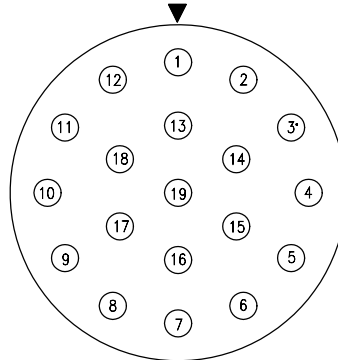

19#16
600VDC

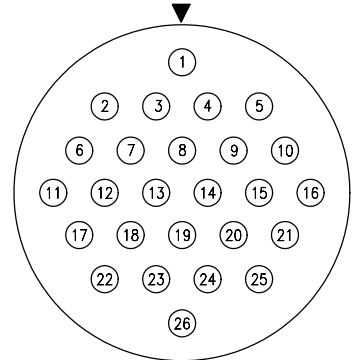

26#20
450VDC

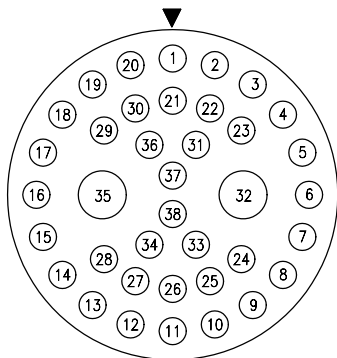

2#10
36#22
300VDC

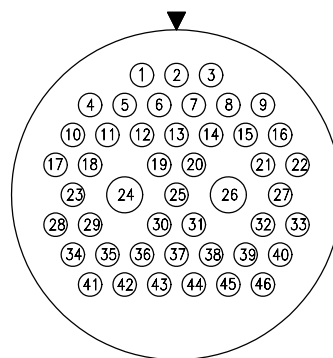

44#22
2#16
300VDC

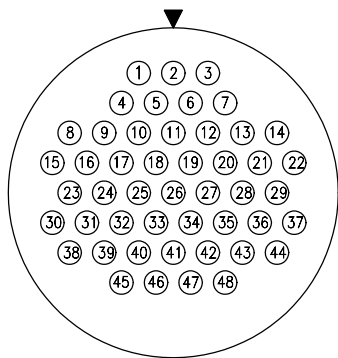

48#22
300VDC

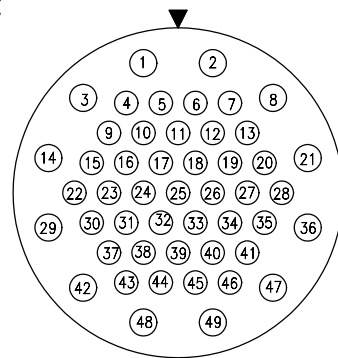

12#20
37#22
300VDC

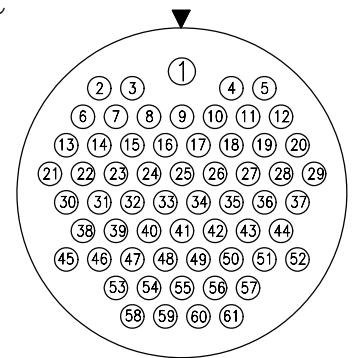

1#20
60#22
300VDC